



The Master of Quality in Steel Construction Materials



master steel

Always Quality & Perfection

COMPANY PROFILE



TABLE OF CONTENTS

Reliable and
Exceptional
Value

5

WHERE
WE STARTED

6

WHO
WE ARE

8

OUR
STRUCTURE

10

OUR
PRODUCTS

RAW
MATERIALS

30

OUR
PARTNERS

32

OUR
CSR



WHERE WE STARTED

The story of recovery and growth of Rwanda cannot be told without the place of construction, being the main element in infrastructure development. The Rwanda story is also one of bold steps taken by Rwandese nationals to steer their country to peace and prosperity.

With the zeal and determination to be part of the great dream for Rwanda, Master Steel was founded in 2005 and moved in to fill the gap required for steel construction materials. Rising from a small operation playing a part in the growth of infrastructure, Master Steel has risen to be the reliable and efficient provider of steel construction products while upholding the Rwandan dream and extending this dream beyond its borders to the African continent. This has been achieved through use of exceptional high quality raw materials, from selected and ISO 9001 certified world class mills, well trained man power, world class science and technology and continuous innovation.

Resilience, zeal and beneficial co-existence have been the foundation on which Master Steel has built to be an integral part of the steel construction products industry. These attributes have seen the company easily emerge as one of the top producers of steel construction material in the Great Lakes region and the market leader in Rwanda.

» OUR VISION AND MISSION

To think brick and mortar is to think Master Steel, at home, in the region and Africa.

Our existence must be of benefit to the customer, environment, citizen and employees. We exist because the stakeholder is satisfied with our presence through provision of cost effective, appropriate and relevant quality goods and services in a friendly environment.

Master steel Limited is a limited liability company incorporated in Rwanda with operations spanning the East and Central African region.

WHAT WE STAND FOR

To confidently take our position in conveying satisfaction to our stakeholders, we hold the following values and exist by them.



QUALITY

To compromise on quality is to shortchange our stakeholders, be it the customer, environment or employee



SAFETY

We operate in an industry where safety is paramount in every area of operation.



INNOVATION AND CREATIVITY

We embrace innovation and creativity in order to be in tandem with the changing times in the industry.



CUSTOMER SATISFACTION

To be professional by acting with integrity, being honest and placing the satisfaction of the customer first at all times.



TEAMWORK

None of us has it all but all of us have it all, teamwork is paramount.



ENVIRONMENT

We cannot exist without our environment, being the source of our raw materials.



EMPLOYEE DEVELOPMENT

We recognize that our workforce can only meet the changing challenges in the industry through continuous employee development programmes.



OUR STRUCTURE

We have a trusted and highly experienced team

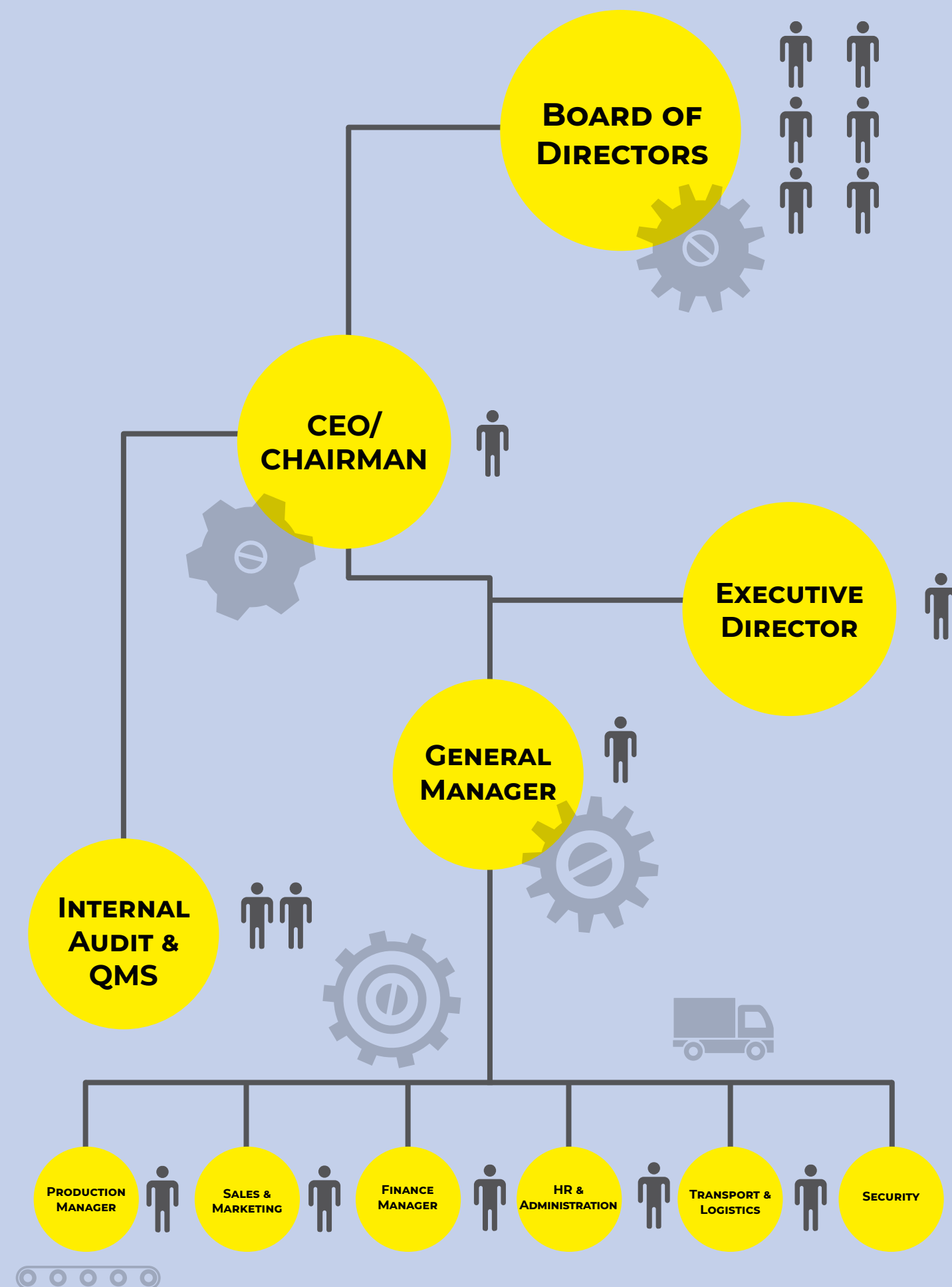

OUR PRODUCTS

• IRON SHEETS

- PREPAINTED IRON SHEET
- FARASI AL-ZINC IRON SHEETS
- SUPER COVER PREPRINTED IRON SHEETS
- EVERTILE

• MILD STEEL PLATES

- MS PLATES
- RIDGES
- VALLEYS
- GUTTERS

• STRUCTURAL HOLLOW SECTIONS

- SQUARE
- RECTANGULAR
- ROUND

• OPEN PROFILES

- DOOR FRAMES
- FASCIA BOARDS
- BOTTLE SECTIONS
- OMEGA PROFILES

• WIRE PRODUCTS

- HIGH TENSILE DEFORMED BARS
- SQUARE BARS
- NAILS & SCREWS

• TRADING ITEMS

- EQUAL ANGLES
- REBARS
- T- SECTION AND FLAT BARS

IRON SHEETS

IRON SHEETS:

- Prepainted iron sheet
- Farasi Al-Zinc iron sheets
- Super Cover Preprinted iron sheets
- Evertile



PREPAINTED IRON SHEETS

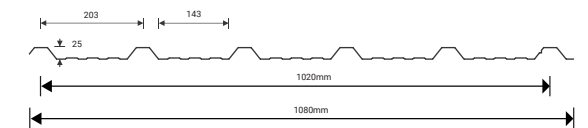

EVERTILE

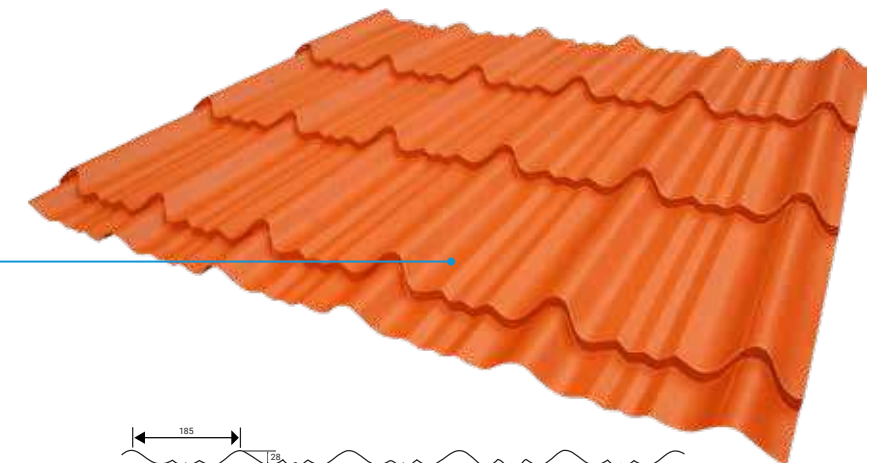

- Cover width 110 mm
- Crimp Pitch 300 mm
- Press depth 18 mm
- Min. length: 1 M Max. length: 12M
- Zn coating class: Z122

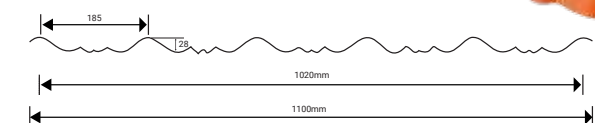



AL-ZINC IRON SHEETS

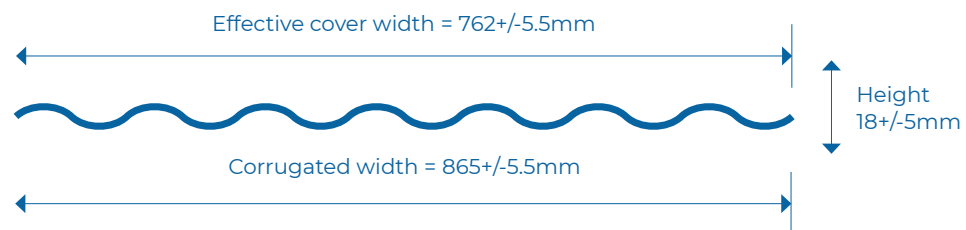

FEATURES AND BENEFITS:

- Long lasting
- Easy to Install
- Shiny Silver Finish
- Cooler Interiors



SUPER COVER PREPAINTED IRON SHEET

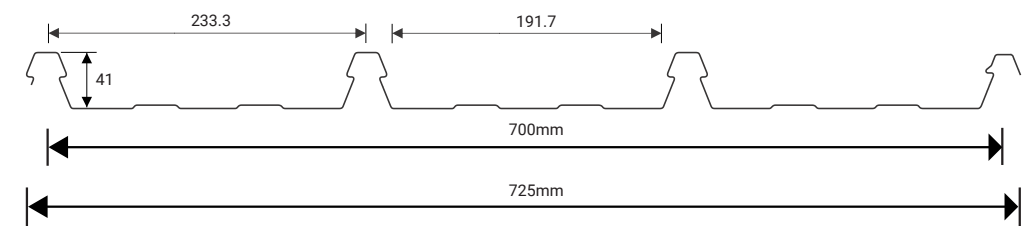



MILD STEEL PLATES

- MS Plates
- Ridges
- Valleys
- Gutters





STRUCTURAL HOLLOW SECTIONS

Application: Fabrication, Construction, Furniture etc.

Square

Rectangular

Round

SQUARE HOLLOW SECTIONS

Technical
Specification

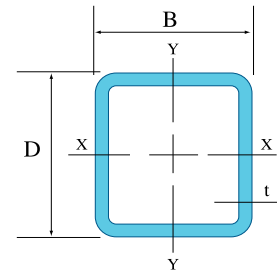

SQUARE HOLLOW SECTIONS										
SIZE (DxB)	THICK- NESS (t)	WEIGHT	PIECES PER M.T.	SECT. AREA	MOMENT OF INERTIA		RADIUS OF GYRATION		SECTION MODULUS	
mm	mm	kg/m		(cm ²)	Ix(cm ⁴)	Iy(cm ⁴)	ix(cm)	iy(cm)	Zx(cm ³)	Zy(cm ³)
16x16	1.0	0.48	347	0.61	0.22	0.22	0.60	0.60	0.28	0.28
	1.2	0.56	298	0.71	0.26	0.26	0.60	0.60	0.32	0.32
	1.5	0.68	245	0.87	0.30	0.30	0.59	0.59	0.38	0.38
20x20	1.0	0.62	269	0.79	0.45	0.45	0.76	0.76	0.45	0.45
	1.2	0.71	235	0.90	0.53	0.53	0.77	0.77	0.53	0.53
	1.5	0.87	192	1.11	0.64	0.64	0.76	0.76	0.64	0.64
	2.0	1.13	147	1.44	0.79	0.79	0.74	0.74	0.79	0.79
25x25	1.0	0.79	211	1	0.92	0.92	0.95	0.95	0.73	0.73
	1.2	0.90	185	1.14	1.08	1.08	0.97	0.97	0.86	0.86
	1.5	1.11	150	1.41	1.30	1.30	0.96	0.96	1.04	1.04
	2.0	1.44	116	1.84	1.63	1.63	0.94	0.94	1.30	1.30
	3.0	2.07	81	2.64	2.17	2.17	0.90	0.90	1.74	1.74
30x30	1.0	0.94	177	1.19	1.62	1.62	1.16	1.16	1.08	1.08
	1.2	1.08	154	1.38	1.91	1.91	1.17	1.17	1.27	1.27
	1.5	1.34	124	1.71	2.32	2.32	1.16	1.16	1.55	1.55
	2.0	1.75	95	2.24	2.94	2.94	1.14	1.14	1.96	1.96
	3.0	2.54	66	3.24	3.99	3.99	1.10	1.10	2.66	2.66
40x40	1.0	1.19	140	1.51	3.95	3.95	1.61	1.61	1.97	1.97
	1.2	1.46	114	1.86	4.67	4.67	1.58	1.58	2.34	2.34
	1.5	1.81	92	2.31	5.71	5.71	1.57	1.57	2.86	2.86
	2.0	2.39	70	3.04	7.34	7.34	1.55	1.55	3.67	3.67
	3.0	3.48	48	4.44	10.20	10.20	1.51	1.51	5.10	5.10
50x50	1.5	2.28	73	2.91	11.42	11.42	1.98	1.98	4.57	4.57
	2.0	3.01	55	3.84	14.77	14.77	1.96	1.96	5.91	5.91
	3.0	4.43	38	5.64	20.85	20.85	1.92	1.92	8.34	8.34
	4.0	5.78	29	7.36	26.15	26.15	10.46	10.46	1.88	1.88
60x60	3.0	5.37	31	6.84	37.14	37.14	2.33	2.33	12.38	12.38
	4.0	7.03	24	8.96	47.07	47.07	2.29	2.29	15.69	15.69
75x75	2.0	4.58	36	5.84	51.91	51.91	2.98	2.98	13.84	13.84
	3.0	6.78	25	8.64	74.78	74.78	2.94	2.94	19.94	19.94
	4.0	8.92	191	1.36	95.75	95.75	2.90	2.90	25.53	25.53
	6.0	13.00	131	6.56	132.40	132.40	2.83	2.83	35.31	35.31
100x100	2.0	6.15	27	7.84	125.54	125.54	4.00	4.00	25.11	25.11
	3.0	9.14	181	1.64	182.71	182.71	3.96	3.96	36.54	36.54
	4.0	12.18	141	5.36	236.34	236.34	3.92	3.92	47.27	47.27
	6.0	17.71	92	2.56	333.59	333.59	3.85	3.85	66.72	66.72
125x125	3.0	11.49	15	14.60	363.00	363.00	4.98	4.98	58.14	58.14
	4.0	15.20	11	19.36	473.00	473.00	4.94	4.94	75.67	75.67
	6.0	22.42	72	8.56	676.00	676.00	4.86	4.86	108.12	108.12
150x150	3.0	13.85	12	17.64	636.00	636.00	6.00	6.00	84.74	84.74
	4.0	18.34	9	23.36	831.00	831.00	5.96	5.96	110.74	110.74
	6.0	27.13	6	34.56	1196.00	1196.00	5.88	5.88	159.53	159.53

RECTANGULAR HOLLOW SECTIONS

ROUND HOLLOW SECTIONS

Technical Specification

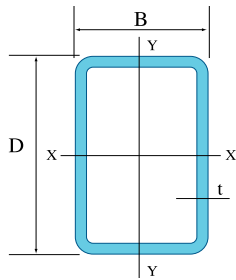

RECTANGULAR HOLLOW SECTIONS										
SIZE (DxB)	THICKNESS (t)	WEIGHT	PIECES PER M.T.	SECT. AREA	MOMENT OF INERTIA		RADIUS OF GYRATION		SECTION MODULUS	
mm	mm	kg/m		(cm ²)	Ix(cm ⁴)	Iy(cm ⁴)	ix(cm)	iy(cm)	Zx(cm ³)	Zy(cm ³)
40x20	1.2	1.08	154	1.38	2.87	0.96	1.44	0.83	1.44	0.96
	1.5	1.40	119	1.71	3.49	1.15	1.43	0.83	1.75	1.15
	2.0	1.76	95	2.24	4.44	1.44	1.14	0.80	2.22	1.43
40x25	1.0	1.01	165	1.29	1.35	2.81	1.02	1.47	1.08	1.4
	1.2	1.18	141	1.50	3.32	1.59	1.49	1.03	1.66	1.27
	1.5	1.46	114	1.86	4.04	1.73	1.47	1.01	2.02	1.54
	2.0	1.91	87	2.44	5.17	2.43	1.45	0.99	2.59	1.94
	3.0	2.78	60	3.54	7.11	3.26	1.42	0.96	3.59	2.61
50x25	1.0	1.01	165	1.29	1.35	2.81	1.02	1.47	1.08	1.4
	1.5	1.69	99	2.15	7.00	2.43	1.80	1.04	2.80	1.87
	2.0	2.23	75	2.84	9.00	2.96	1.78	1.02	3.60	2.37
	3.0	3.25	51	4.14	12.55	3.99	1.74	0.96	5.02	3.19
60x40	1.2	1.84	91	2.34	12.12	6.48	2.27	1.66	4.04	3.24
	1.5	2.28	73	2.90	14.89	7.93	2.26	1.65	4.96	3.96
	2.0	3.01	55	3.83	19.31	10.22	2.24	1.63	6.43	5.11
	3.0	4.43	38	5.64	27.38	14.31	2.21	1.59	9.12	7.10
75x50	2.0	3.73	45	4.84	38.50	20.50	2.82	2.06	10.20	8.21
	3.0	5.60	30	7.14	55.30	29.10	2.78	2.02	14.7	11.60
	4.0	7.34	23	9.36	70.50	36.70	2.74	1.98	18.80	14.70
100x50	3.0	6.78	25	8.64	112.00	37.40	3.60	2.08	22.40	14.90
	4.0	8.92	19	11.30	144.00	47.30	3.56	2.04	28.80	18.90
	2.0	4.58	36	5.84	26.3	77.52	2.12	3.64	10.50	15.5
125x75	2.0	6.15	27	7.84	172.53	78.56	4.69	3.17	27.60	20.95
	3.0	9.14	18	11.64	251.74	113.68	4.65	3.13	40.28	30.32
	4.0	12.06	14	15.36	326.47	146.21	4.61	3.09	52.24	38.99
	6.0	17.71	9	22.56	463.18	203.99	4.53	3.01	74.11	54.40
150x50	3.0	9.14	18	11.60	311.00	54.00	5.18	2.15	41.50	21.60
	4.0	12.06	14	15.30	404.00	68.50	5.14	2.11	53.80	27.40
	6.0	17.71	9	22.56	574.03	93.15	5.04	2.03	76.54	37.26
150x100	3.0	11.4	15	14.6	253	473	4.16	5.69	50.69	63.1
	4.0	15.2	11	19.3	328	617	4.12	5.65	65.7	82.3
	6.0	22.4	7	28.5	466	885	4.04	5.57	93.2	118
200x100	3.0	13.85	12	17.64	947.00	324.00	7.33	4.28	94.72	64.78
	4.0	18.34	9	23.36	1240.00	421.00	7.29	4.24	124.03	84.15
	6.0	27.13	6	34.56	1794.00	599.00	7.20	4.16	179.39	119.81

Technical Specification

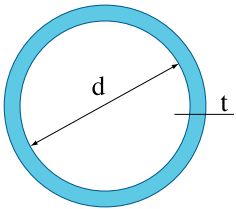

ROUND HOLLOW SECTIONS							
SIZE (d)	THICKNESS (t)	WEIGHT	PIECES PER M.T.	SECTION AREA	MOMENT OF INERTIA	RADIUS OF GYRATION	SECTION MODULUS
mm	mm	kg/m		(cm ²)	Ix(cm ⁴)	i(cm)	Z(cm ³)
16	1.2	0.44	379	0.56	0.15	0.52	0.19
	1.5	0.54	309	0.68	0.18	0.52	0.23
	2.0	0.71	235	0.88	0.22	0.27	0.5
20	1.2	0.59	283	0.71	0.31	0.67	0.31
	1.5	0.75	222	0.87	0.38	0.66	0.38
22	1.2	0.62	269	0.78	0.43	0.74	0.39
	1.5	0.76	220	0.97	0.51	0.73	0.46
25	1.2	0.70	237	0.90	0.64	0.84	0.51
	1.5	0.87	192	1.11	0.77	0.83	0.61
32	1.2	0.91	183	1.16	1.38	1.09	0.86
	1.5	1.13	148	1.44	1.68	1.08	1.05
38	1.2	1.12	149	1.39	2.35	1.30	1.24
	1.5	1.38	121	1.72	2.87	1.29	1.51
42.25	1.2	1.21	137	1.55	3.26	1.45	1.54
	1.5	1.54	108	1.92	3.99	1.44	1.89
	2.0	1.90	87	2.53	5.13	1.42	2.43
48.25	1.2	1.39	120	1.77	4.91	1.66	2.04
	1.5	1.73	96	2.20	6.02	1.65	2.50
	2.0	2.28	73	2.91	7.78	1.64	3.23
60	1.5	2.16	77	2.76	11.80	2.07	3.93
	2.0	2.86	58	3.64	15.34	2.05	5.11
	2.5	3.54	47	4.52	18.70	2.03	6.23
76	2.0	3.75	44	4.65	31.85	2.62	8.38
	2.5	4.53	37	5.77	39.02	2.60	10.27
89	2.0	4.29	39	5.47	51.74	3.08	11.63
	2.5	5.37	31	6.79	63.59	3.06	14.29



OPEN PROFILES

Application: industrial buildings, commercial buildings, public buildings, sport buildings, educational buildings, offices and administration buildings, multi-story buildings power plants, residential house, high design demand buildings, etc.

- Door frames
- Fascia Boards
- Bottle sections
- Omega Profiles



DOOR FRAMES



FASCIA BOARDS

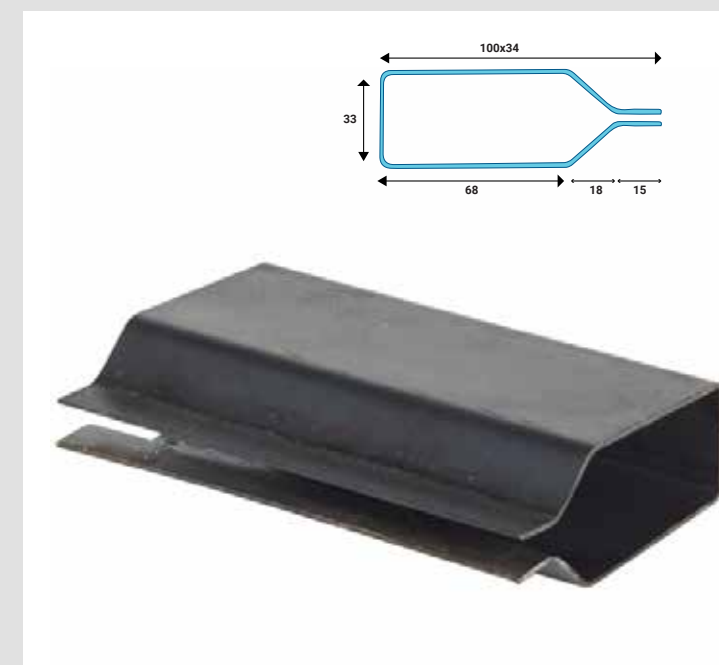

BOTTLE SECTIONS



OMEGA PROFILES



WIRE PRODUCTS

- High Tensile Deformed Bars
- Round Bars
- Nails & Screws



**HIGH TENSILE DEFORMED
BARS**



ROUND BARS

NAILS



WIRE NAILS



ROOFING NAILS



SELF TAPPING SCREWS

WIRE NAILS			
SIZE (INCHES)	LENGTH(CM)	SHANK(WIRE) DIAMETER (CM)	STD WT/BAG (KGS)
6.0	15	0.6	50
5.0	12	0.55	50
4.0	10	0.45	50
3.0	8	0.40	50
2.5	6	0.33	50
2.0	5	0.27	50
1.5	4	0.23	50
1.0	3	0.18	50



TRADING ITEMS

- Equal Angles
- Rebars
- T- Section and Flat Bars

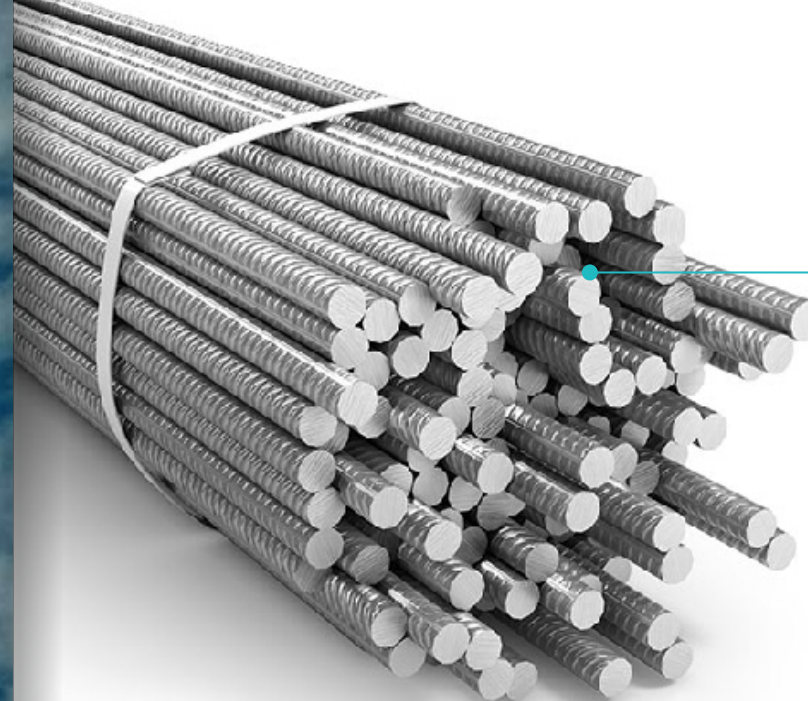

Size: Length: 12 Mtrs	Weight per pcs (Kg)
8 mm	4.76
10 mm	7.41
12 mm	10.70
14 mm	14.49
16 mm	18.87
20 mm	29.41
25 mm	45.45

REBARS

Used in reinforced concrete, road construction etc.

EQUAL ANGLES

Used in Doors, Beds, Furniture, Racks & Shelves, etc

Size: (mm)	Weight per pcs (Kg)
25x25x2.5	5.9
25x25x3.0	6.7
30x30x2.5	6.5
40x40x3.0	7.8
40x40x5.0	11.0
50x50x3.0	18.9
50x50x4.0	13.5
50x50x5.0	18.5
75x75x6.0	22.5
25 mm	41.5

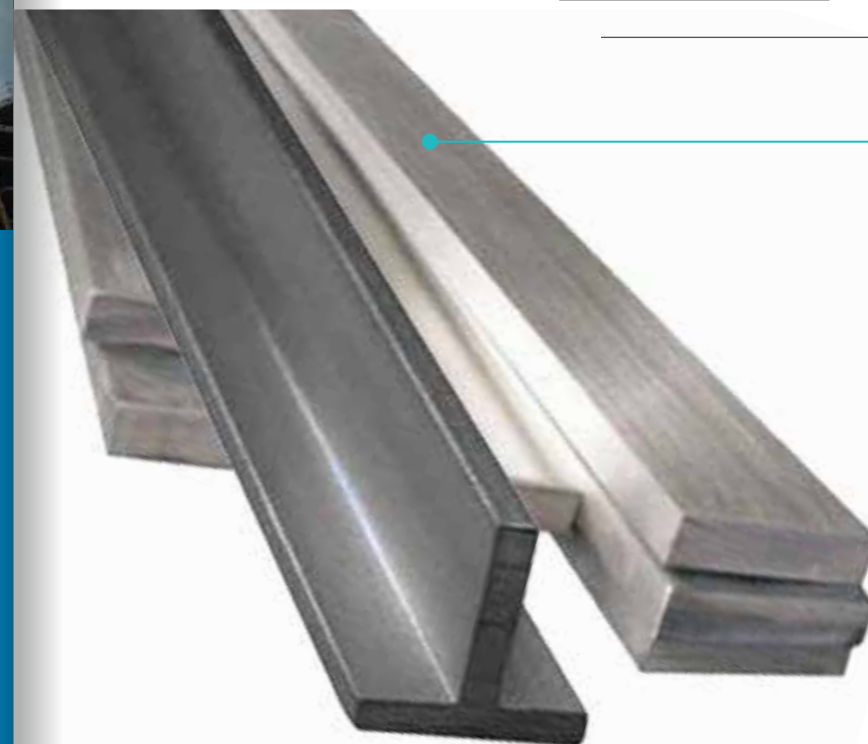
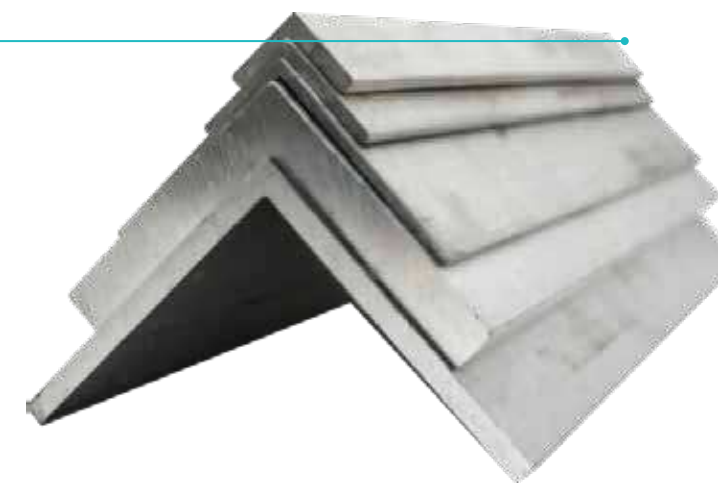

T- SECTION AND FLAT BARS

RAW MATERIALS

• STEEL SHEET COILS •

• COLOR COATED COILS •

• WIRE ROD COILS •



OUR PARTNERS

Master Steel believes in creating and nurturing mutually beneficial linkages with partners to achieve efficiency, quality services and customer satisfaction.

Our partners are professionals in their fields, trusted and dependable.

CERTIFICATION



In Distribution, Supplies and Consultancy
We Partner with the following:

DISTRIBUTION PARTNERS

- ▶ Domitien/Q.Ineza
- ▶ Jesco Ltd
- ▶ Trust Hardware
- ▶ Kamuru Trading Co. Ltd
- ▶ Danube Hardware Ltd
- ▶ Q Wing Co.Ltd
- ▶ Bwanakweli's Family
- ▶ Star Trading Co. Ltd
- ▶ Karegeya Japhet
- ▶ Kandest Trading Co. Ltd
- ▶ Mwendo Traders
- ▶ Sis Side Business
- ▶ Bethel Supply
- ▶ Q.Efficiency
- ▶ Eritacom Ltd
- ▶ JMV
- ▶ Great Supply & Services Ltd
- ▶ Megawatt
- ▶ The Home Store
- ▶ Niyo Plus

SUPPLIES PARTNERS

- ▶ Mill Steel
- ▶ Mac Steel
- ▶ Steel Force
- ▶ Uni Steel
- ▶ Tianjin
- ▶ Apex
- ▶ Harjit

CONSULTANCY PARTNERS

- ▶ Ingeri Consulting Company
- ▶ Argec Consulting Company
- ▶ ORAS

MASTER STEEL SOCIAL RESPONSIBILITY VENTURES

Master Steel believes in
the power of an educated
population

We operate in a society and environment where there is a good segment of the population which is disadvantaged through no fault of their own. Master Steel is involved in community activities which work towards uplifting the living standards of the disadvantaged. We provide construction material to vulnerable members of society in select areas. This has seen such members benefitting with fairly decent houses.

Master Steel believes in the power of an educated population. It is indeed this population which is the backbone of the company as it offers the human resources without which operations ground to a halt. In recognition of this important part education plays, we partner with government agencies and actively participate in construction of public schools through provision of materials as well as expertise.

We are proud to be associated with the progressive steps in our education sector and continue to play our role.

ACHIEVEMENTS - RWANDA DEVELOPMENT BOARD'S BUSINESS EXCELLENCE AWARDS



Master Steel, Rwanda was recognised as the Investor of the Year, 2020 in the awards that seek to recognize businesses that have demonstrated excellence, and also proved to have significantly contributed to the country's economic transformation.

KK 15 Rd. Gahanga Sector,
Kicukiro District
P.O Box 2318 Kigali - Rwanda.
Tel. (Office) +250 788 33 44 44,
Website: www.mastersteel.co